



FAMATEC FRIENDLY FR-V

Gripping system with 4 adjustable suction cups for handling flat glasses/panels

Column configuration

Brakes on all rotation axes.
Suction pads can be quickly adjusted.
Console quickly adjustable in height.

Features:

Pneumatic tilting 90°
Pneumatic rotation 90°

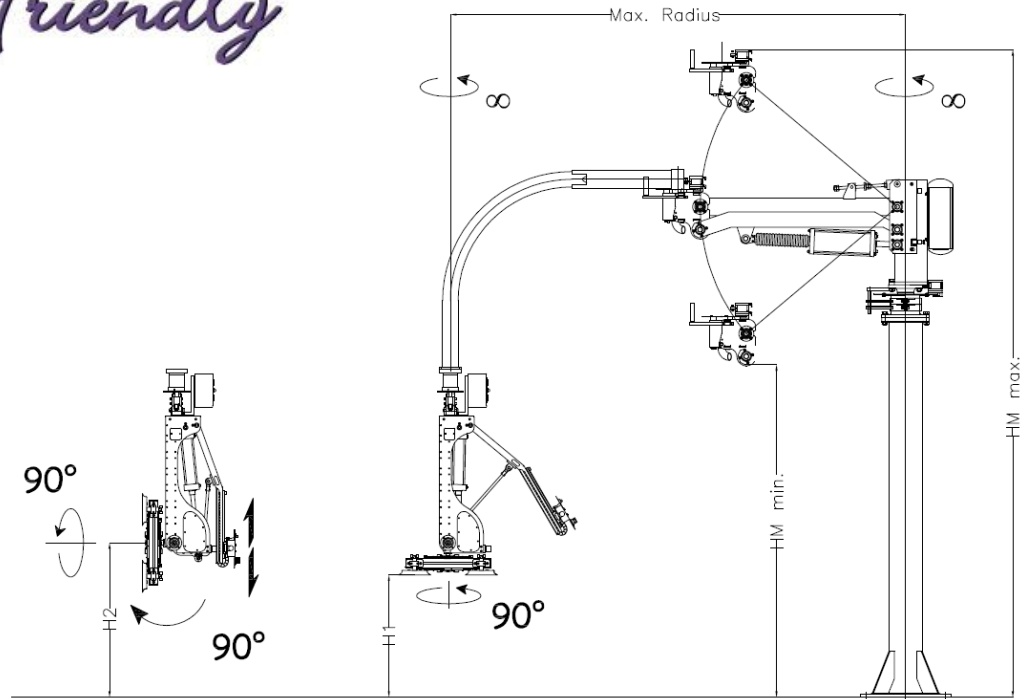
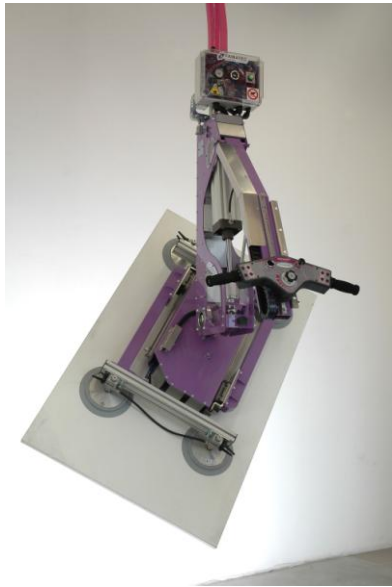

Load capacity (Kg/lbs.)	Nominal Radius (mm/ft.)	H1 (mm/in.)		H2 (mm/in.)		HM (mm/in.)		Products min. dimensions (mm/in.)
		Min.	Max.	Min.	Max.	Min.	Max.	
150/330	3.000/9.8	0	1.500/59	340/13	1.700/67	2.000/79	4.010/158	1.250x500/49x19 ^[1]
250/550	2.750/9	0	1.500/59	420/17	1.750/69	2.000/79	4.010/158	1.250x550/49x21 ^[2]
400/880	3.000/9.8	0	1.450/57	550/22	1.700/67	2.170/85	4.200/166	1.500x800/59x31 ^[3]
500/1100 ^[5]	2.750/9	0	1.450/57	550/22	1.700/67	2.170/85	4.200/166	1.500x800/59x31 ^[4]

^[1] 800x600 (32"x24") with quick adjustable suction pads kit 1600x250 (64"x10") with aligned suction pads

^[2] 1250x300 (49"x12") gripping with 2 suction cups. Load capacity -> 125 Kg. 9275 lbs.)

^[3] 1500x400 (59"x16") gripping with 2 suction cups. Load capacity -> 200 Kg. (440 lbs.)

^[4] 1500x400 (59"x16") gripping with 2 suction cups. Load capacity -> 250 Kg. (550 lbs.)

^[5] 8 bar (116 psi.) air pressure required

For fixing the column to the floor, a floor slab class C20/25 (ENV 206) with minimum thickness of 200mm (8") is needed.

